

2 People
Recommended



Holds up to
275 lb (124.7 kg)

Parts and Tools



**HEADREST
x1**

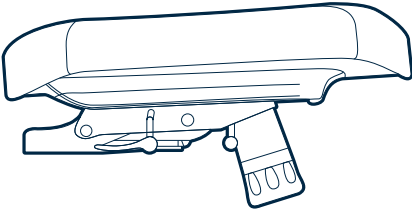

**CHAIR SEAT
x1**

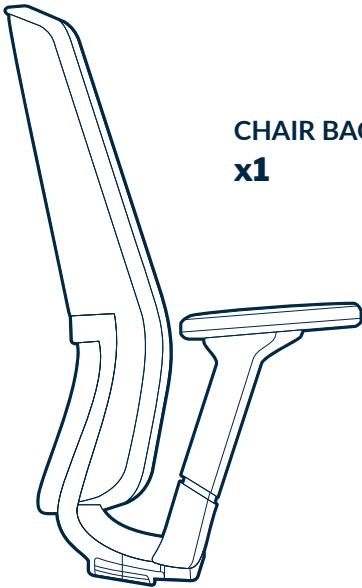

**CHAIR BACK
x1**



**PISTON
x1**

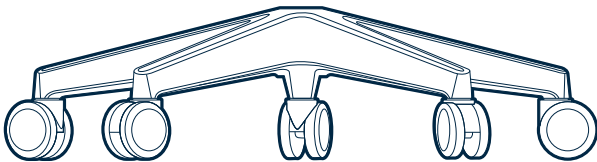

**BASE
x1**

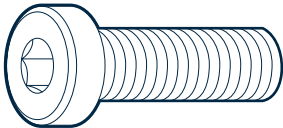

**SCREW
x2**



**ALLEN KEY
x1**

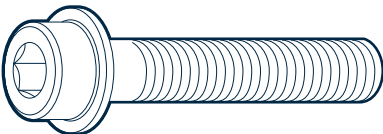

**HEX SCREW
x3**

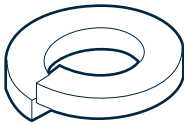

**SPRING WASHER
x3**

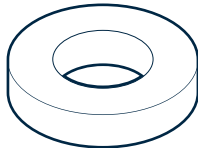

**FLAT WASHER
x3**

Chair Assembly

1

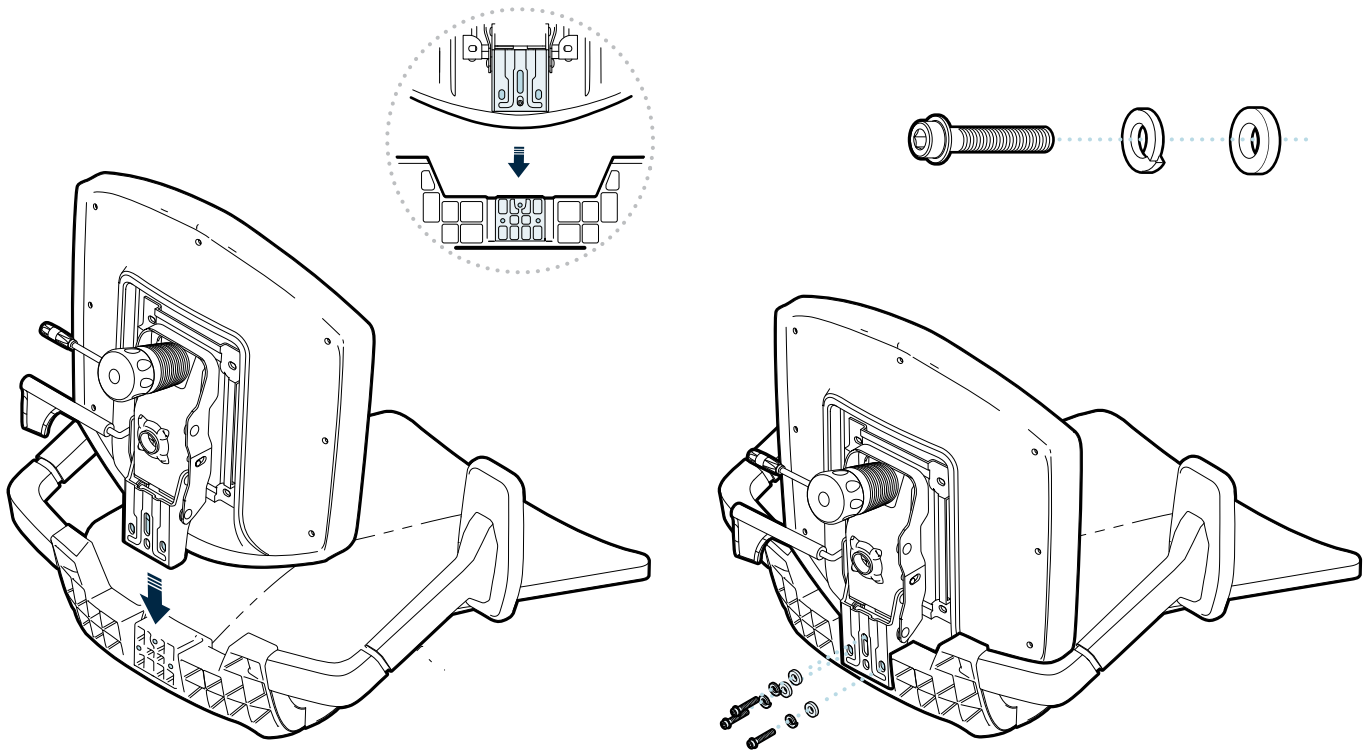

Align the back of the chair with the steel plate attached to the seat. Using the washers and hex screws provided, fasten the plate to the back of the chair with the Allen key.

2

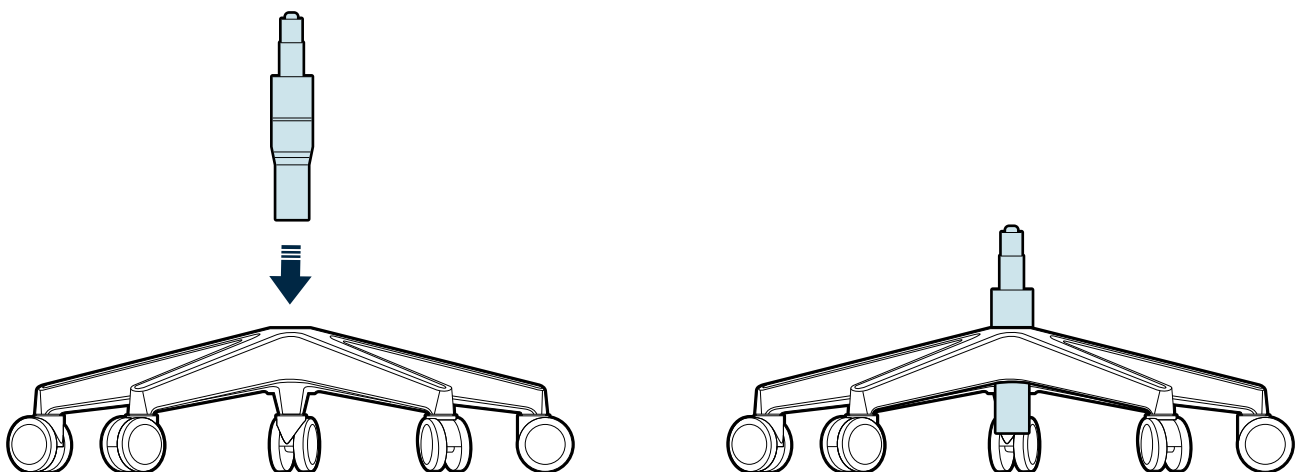

Remove the air piston and base from the packaging. Insert the piston into the base with the large end down, as shown.

3

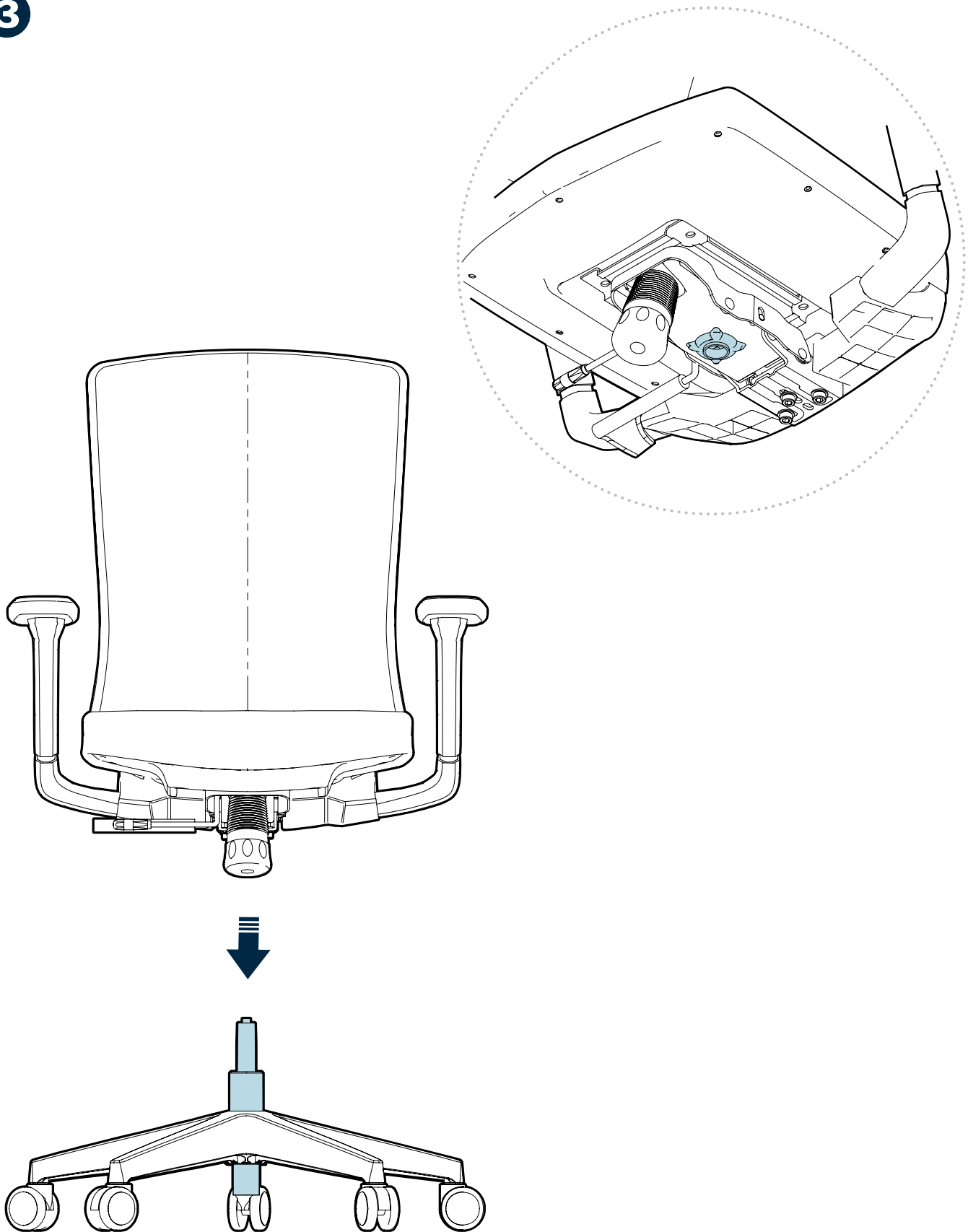

With assistance, flip the chair assembly onto the base assembly, lining up the hole with the top of the piston. Using even pressure, press firmly on the seat cushion a few times to ensure the seat is fully engaged with the piston.

NOTE: Once assembled, do not attempt to disassemble the chair, as doing so may damage the product.

4

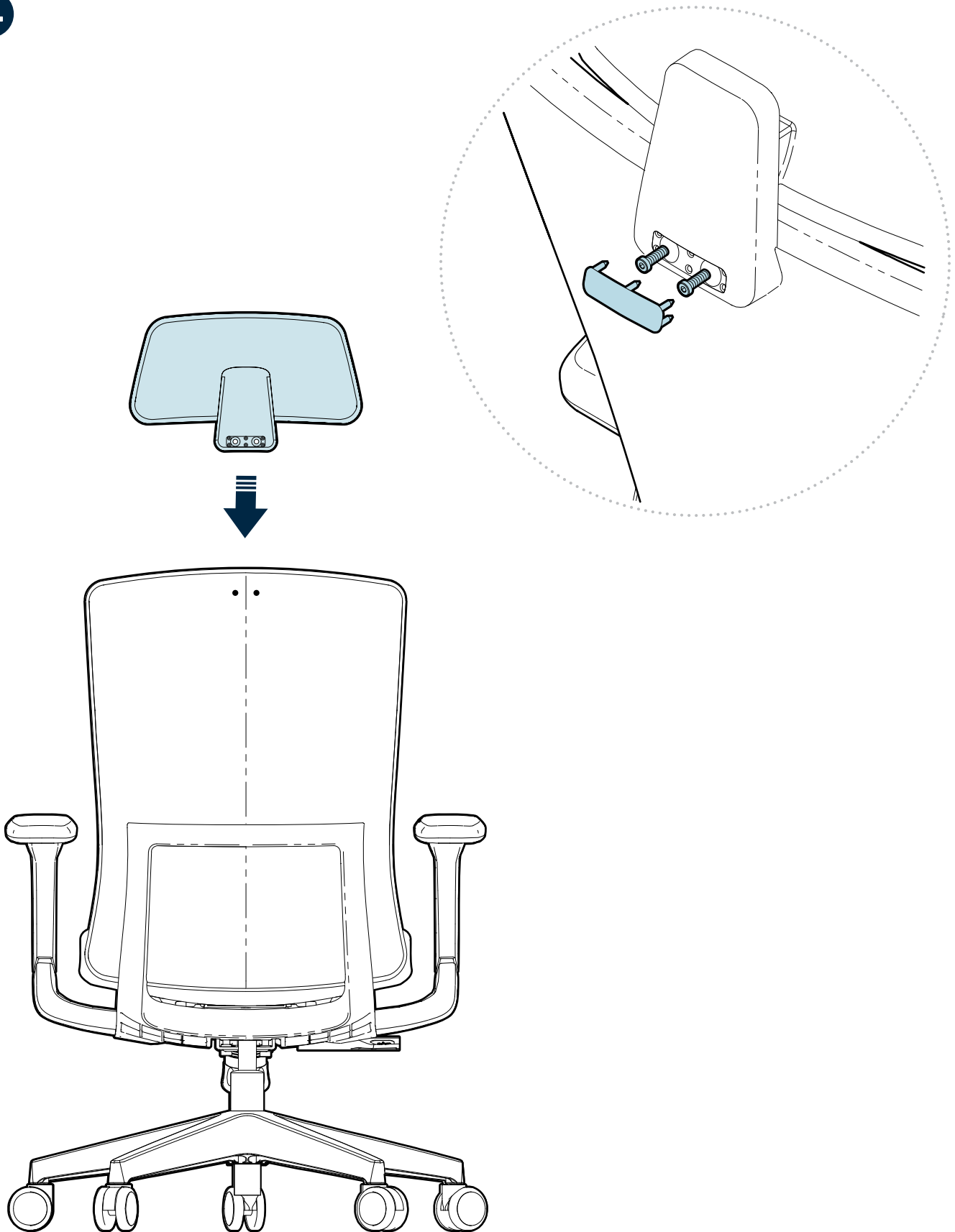

Align the holes on the headrest with the holes on the back of the chair. Use the provided Allen Key and Screws to secure the headrest. Once fastened, align and firmly push the cover piece into place.

Chair Adjustments

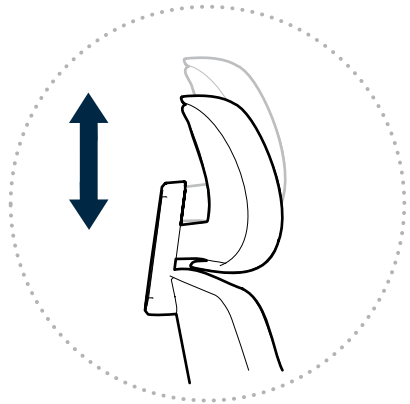

To adjust the headrest's height, gently pull up to raise and push down to lower.

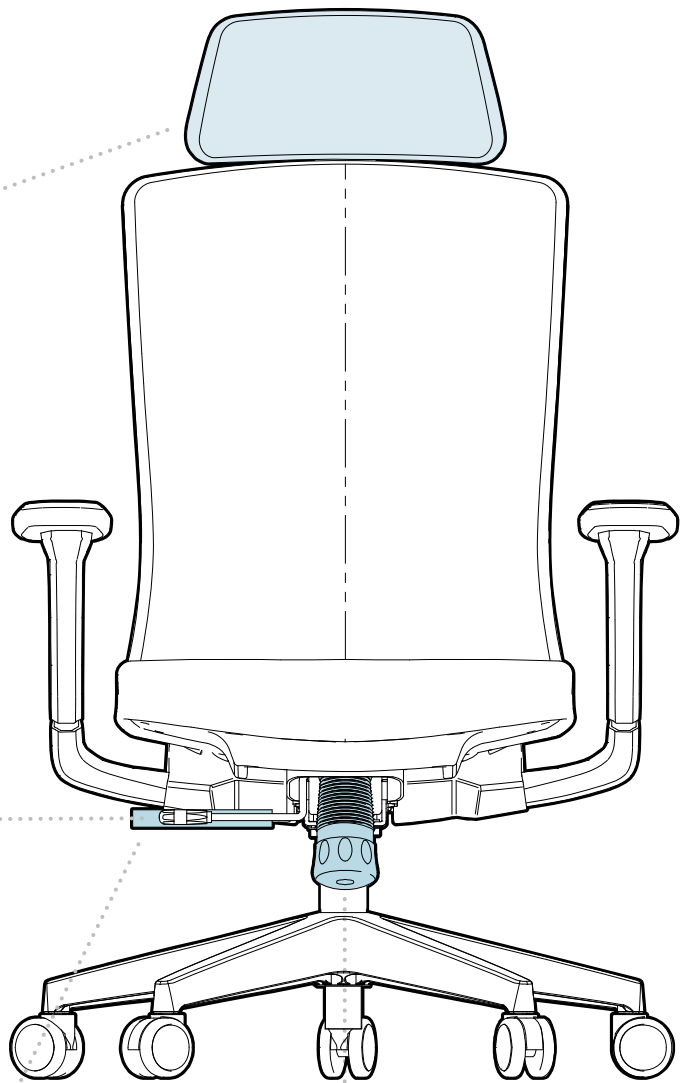

To adjust the seat height, engage the back lever under the right side of the seat, and adjust the seat height to the desired setting.



To allow the chair backrest to recline, slide the back lever under the right side of the seat out. To prevent the backrest from reclining, push the lever in.



To adjust how easily the chair back reclines, turn the knob under the front of the seat clockwise to increase tension and counter-clockwise to decrease tension.

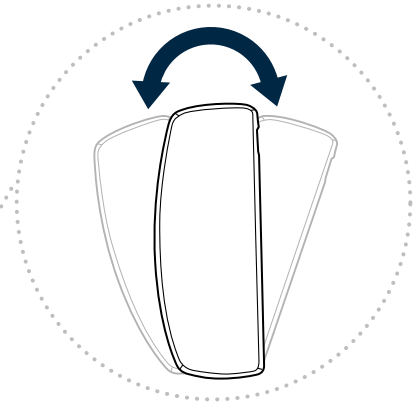
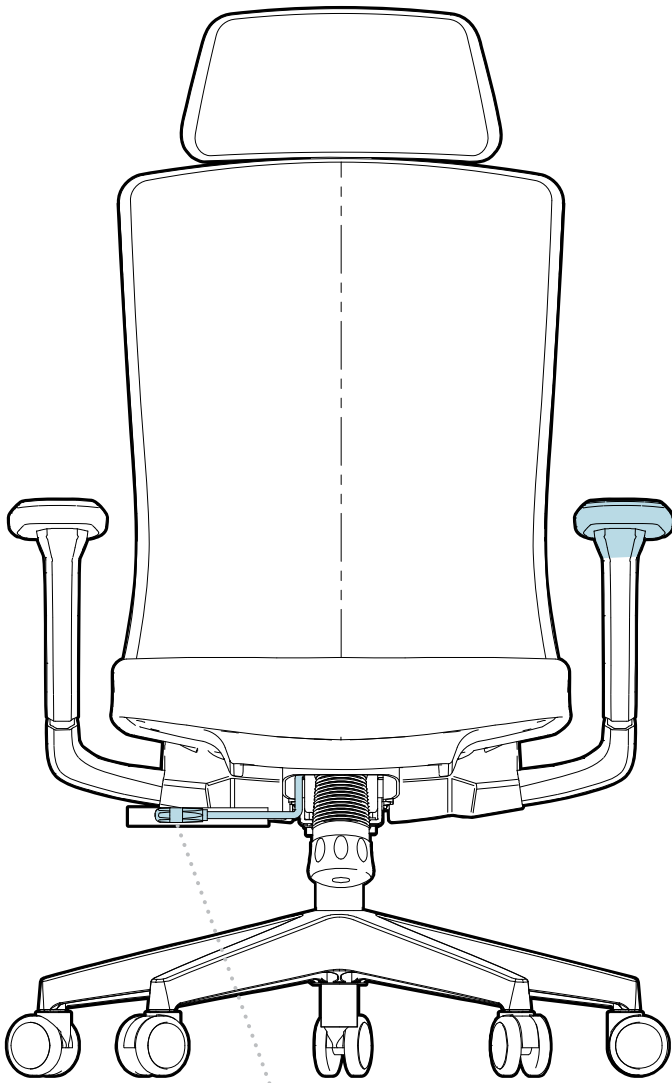

To angle the armrests or slide armrests from front to back, push armrests accordingly.

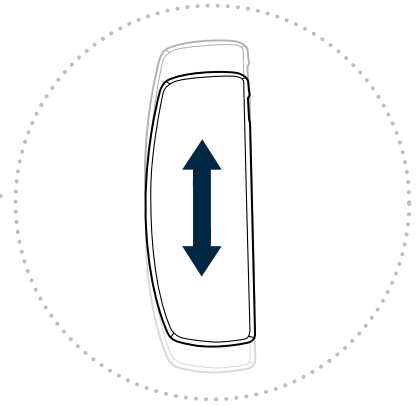

To adjust the position of the seat cushion, engage the front lever under the right side of the seat, then slide the seat forward or backward into the desired position.

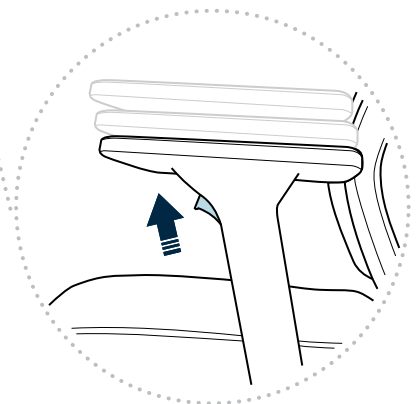

To adjust the arm height, press the button under the armrest and pull up or push down on the armrest.



WARNING: To prevent injuries and product failure, do not use this chair for standing, climbing, or leaning. Do not use if the chair is damaged or incorrectly assembled.



(800) 207-2587